

FAMILY ASPIRE 20

3 BEDROOMS | 2.5 BATHS | 1,710 SQ. FT. | 20' POCKET

MAIN FLOOR

1,710 SQ. FT.

Your work and home lives are starting to take off and you want a home that gives you everything you need while supporting how you live.

With **Family Aspire** you can have it all. A kitchen designed for casual dining and quick meal prep with a view of the open-concept main floor and great room where all the family activities happen. The family entrance and storage room gives you a place for seasonal wear and sports equipment. More space for your family to grow. This home was designed to help you build a foundation for an amazing life.

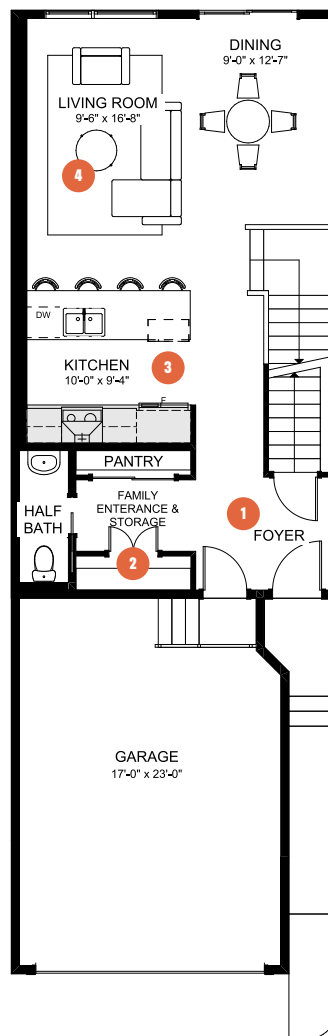

- 1** Functional family entrance to seamlessly get everyone in and out of the house
- 2** Handy storage space for keeping seasonal wear and weekend activity equipment organized

- 3** Kitchen with great flow for easy meal prep and watching the kids as they play
- 4** Spacious living room with space for everyone to put their feet up



FAMILY ASPIRE 20

3 BEDROOMS | 2.5 BATHS | 1,710 SQ. FT. | 20' POCKET

SECOND FLOOR 990 SQ. FT.

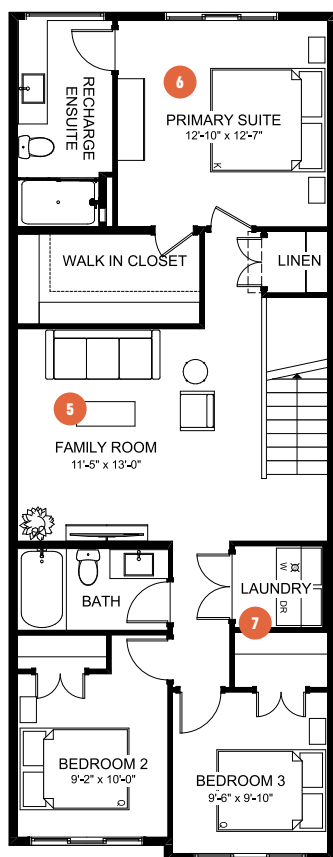

BASEMENT DEVELOPMENT OPTION 573 SQ. FT.

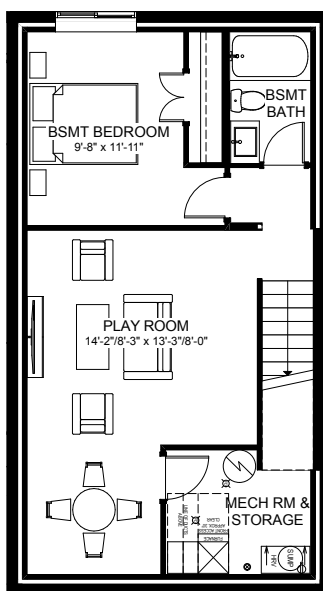

- 5** Spacious family room for sharing quality time together
- 6** Oversized primary suite to provide extra space for personal downtime

- 7** Convenient second floor laundry to make washing and drying a breeze